



Main Features:-

- ◆ Strainer for Check Valve, BSP
- ◆ Materials used: 80217 AISI 316, 80215 AISI 304
- ◆ Threaded ends PN 16 bar
- ◆ Working Temperature -20 to + 150C *

*Temperature and pressure determined by valve body, seat etc.

Suitable Applications & Approvals:



HVAC



OIL



GAS



INDUSTRY



ATEX



SERIES: 80217/80215

MANUFACTURER: **GENEBRE**

VALVE MATERIALS & DIMENSIONS

ITEM	SECTION	MATERIAL	ADDITIONAL INFO / OPTIONS
1	Threaded end	AISI 316	AISI 304
2	Mesh	AISI 316	AISI 304
3	Base	AISI 316	AISI 304

REF	SIZE	A	B	C	D	E	F	G	H	Kg
80217-04	1/2"	1/2"	56.5	17.5	22	23	4	10	15	0.021
80217-05	3/4"	3/4"	62.5	22	28	29	4	10	15	0.02
80217-06	1"	1"	70	28.5	36	37	4	10	15	0.035
80217-07	1 1/4"	1 1/4"	80	36.5	43	44	5	14	20	0.055
80217-08	1 1/2"	1 1/2"	90	42.5	48	49	5	14	20	0.065
80217-09	2"	2"	100	54.5	61	62	5.5	14	20	0.085
80217-10	2 1/2"	2 1/2"	115	70.5	79.5	80.5	5.5	16	25	0.147
80217-11	3"	3"	125	83	92	93	6	16	25	0.185
80217-12	4"	4"	145	108	116	117	6	16	25	0.26

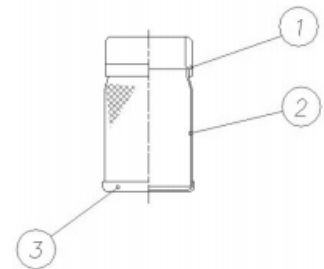

MESH DETAIL

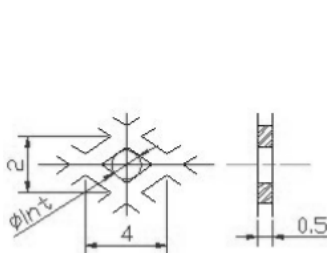

Filter 1/2" -> 2"
Øint max = 1mm.

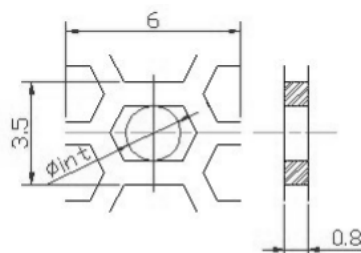

Filter 2 1/2" -> 4"
Øint max = 1.9mm.

ALL VALVES

AllValves Online™ have used decades of experience in the valve industry to select a range of products that match the AllValves Online ethos - value for money. All Valves Products are from reputable sources and have been sold in significant quantities for many years, are installed in a wide variety of applications, and are known to be durable in service.



T +44 (0)1386 552369

E sales@allvalves.co.uk

W www.allvalves.co.uk

F +44 (0)1386 554227



Genebre are a global brand of industrial valves with large stocks held for fast delivery on various type of valves, sizes, end connections and materials.

SERIES: 244x

TORQUE / Kv VALUES / PRESSURE & TEMP CHART

REF	SIZE	TORQUE Nm	REF	SIZE	Kv
80217-04	1/2"	5Nm	80217-04	1/2"	19
80217-05	3/4"	8Nm	80217-05	3/4"	40
80217-06	1"	10Nm	80217-06	1"	65
80217-07	1 1/4"	14Nm	80217-07	1 1/4"	110
80217-08	1 1/2"	20Nm	80217-08	1 1/2"	180
80217-09	2"	30Nm	80217-09	2"	365
80217-10	2 1/2"	36Nm	80217-10	2 1/2"	495
80217-11	3"	60Nm	80217-11	3"	970
80217-12	4"	95Nm	80217-12	4"	1620
UPON REQ.	5"	150Nm	244x-13	5"	2530
UPON REQ.	6"	210Nm	244x-14	6"	4050
UPON REQ.	8"	410Nm	244x-16	8"	8650

TORQUE :

- The liquid listed in the table are initial breakaway torques, taken with liquids and lubricant media.

- Please regard these as approximate values, as the objective value on different factors like pressure, medium, rubber,

KV VALUES:

- The Kv values (M3 per hour) is the flow of water at a temperature of 5C to 30C (41F to 86F) at p of 1 bar

- For further information, please email sales@allvalves.co.uk

PRESSURE AND TEMPERATURE CHART

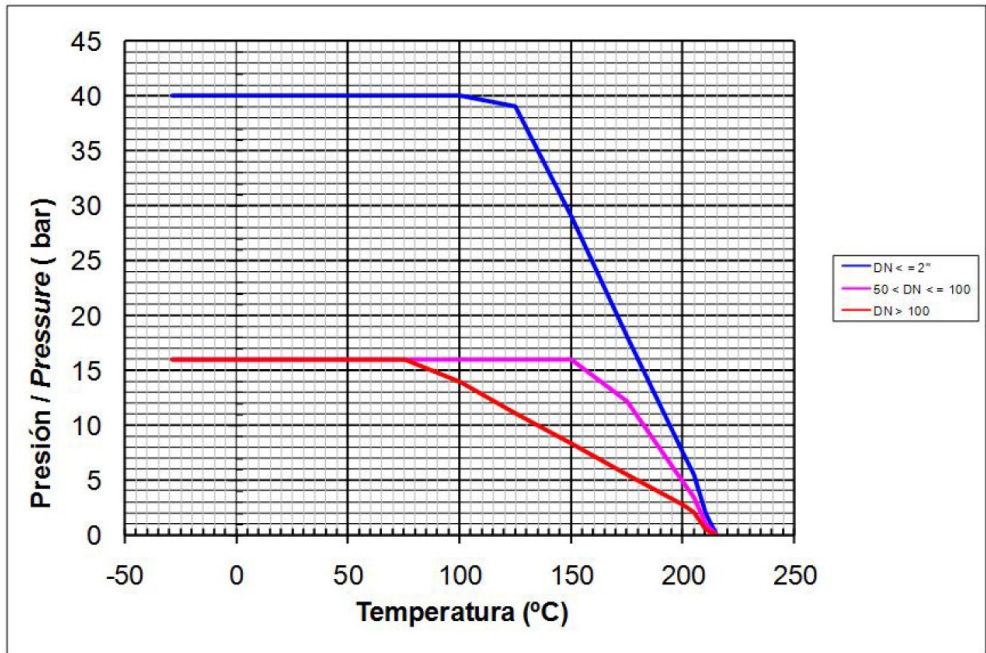

(1 bar = 0,1 MPa ; 1 MPa = 1 N/mm²)

ATEX APPROVED?

The Genebre 244x is the only ATEX certified product currently in the GENE BRE range and is certified to;

Area Classification: II 2 GD

Gas Group: IIC

Dust Group: IIC

Thermal Class: T6 to T3

Temperature Use: -20C to + 60C

See separate ATEX certificate and documentation for full details on where you should and shouldn't use the 244x for ATEX applications.



T +44 (0)1386 552369

E sales@allvalves.co.uk

W www.allvalves.co.uk

F +44 (0)1386 554227